

C-2 輸送機

1 / 144 スケール



詳細データ (C-2)

乗員：3名 (操縦士2名・ロードマスター1名)

2～5名 (補助席) + 110名 (貨物室)

全長：43.9m

全高：14.2m

翼幅：44.4m

飛行速度 (最大) マッハ 0.82



②5 飾り台







(C) Copyright 2006-2020 Ojimak All right a reserved.

Flying Paper Model by Ojimak

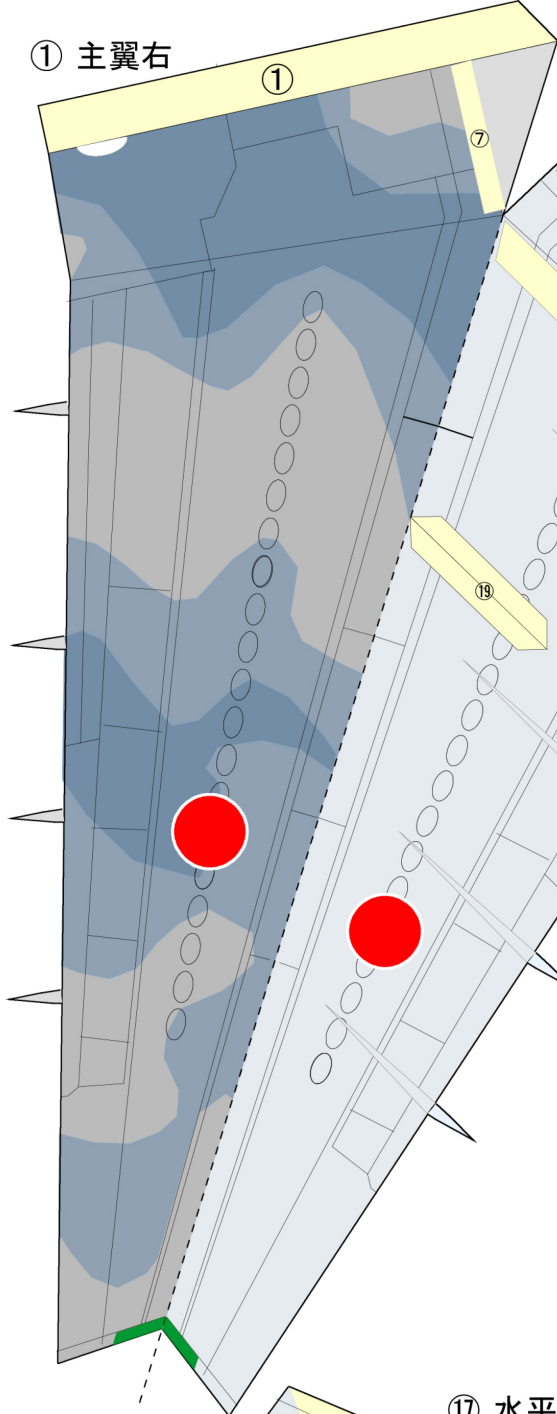
2020.2.11

① 主翼右

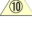
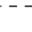

-  同じ記号どうしを糊付け
-  部品内で糊付け
-  番号の部品の裏に糊付け
-  やま折り
-  たに折り
-  切り線

①⑦ 水平尾翼

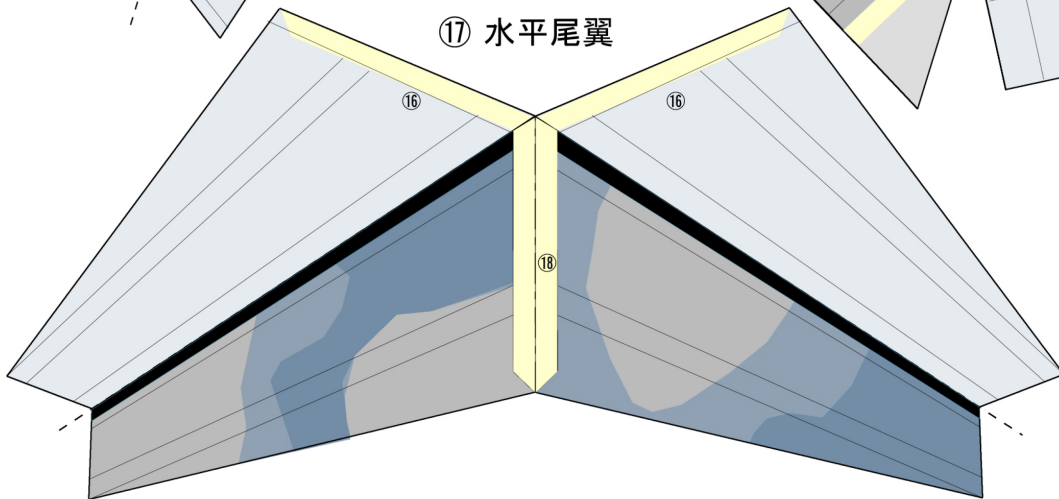

② 主翼左

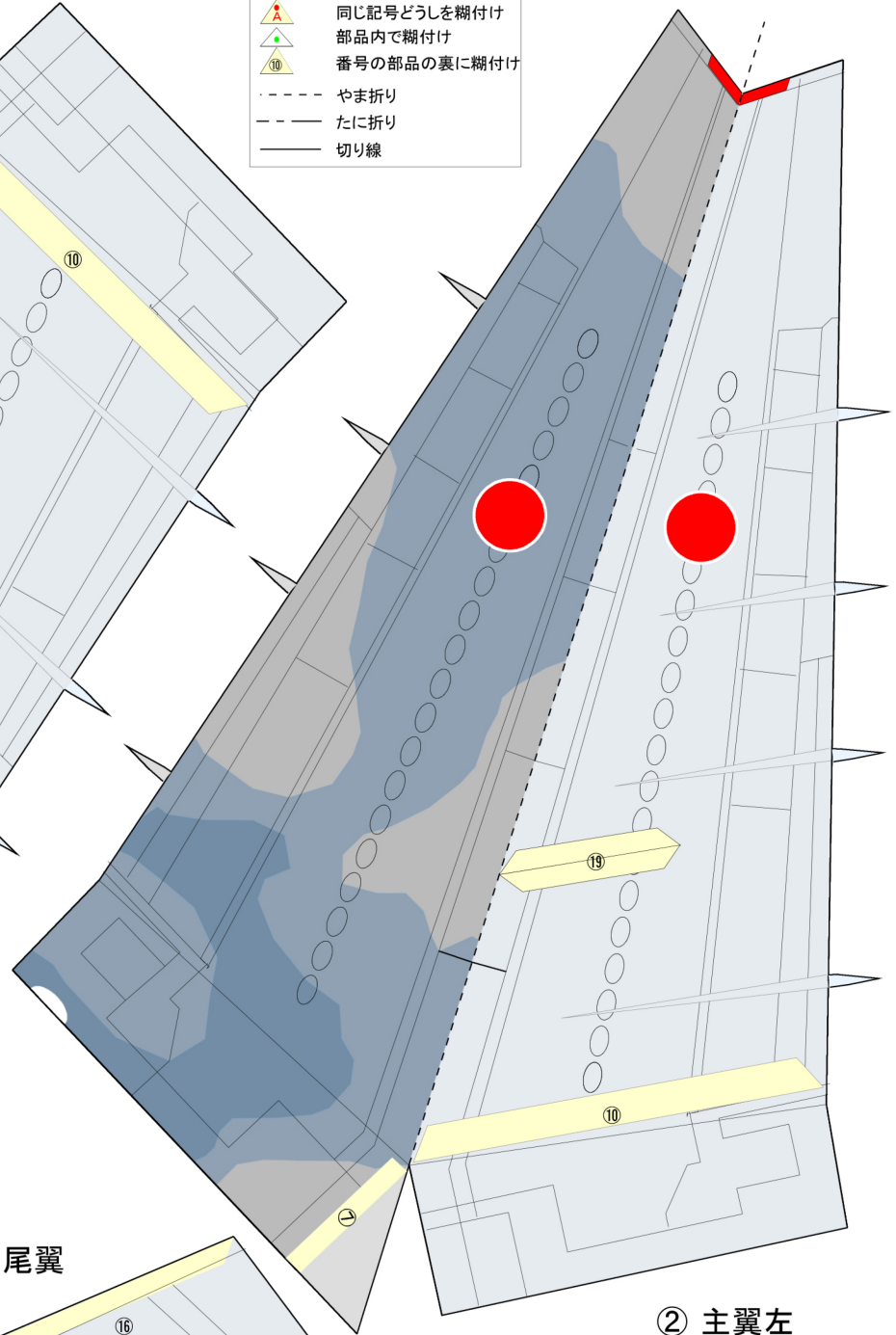

②③ 垂直尾翼補強2左

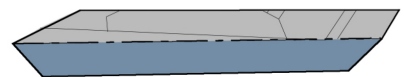

②④ 垂直尾翼補強2右

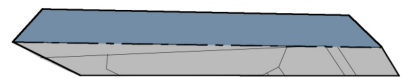

⑧ 機首おもり1



⑤ 機首1

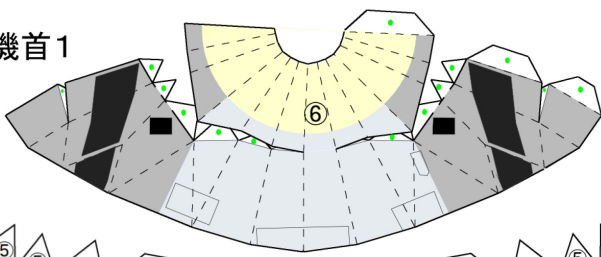

⑥ 機首2

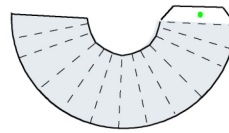

⑭ 車輪ハウス右

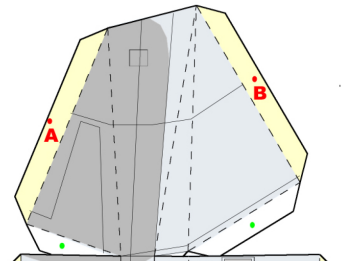

⑦ 機体前部

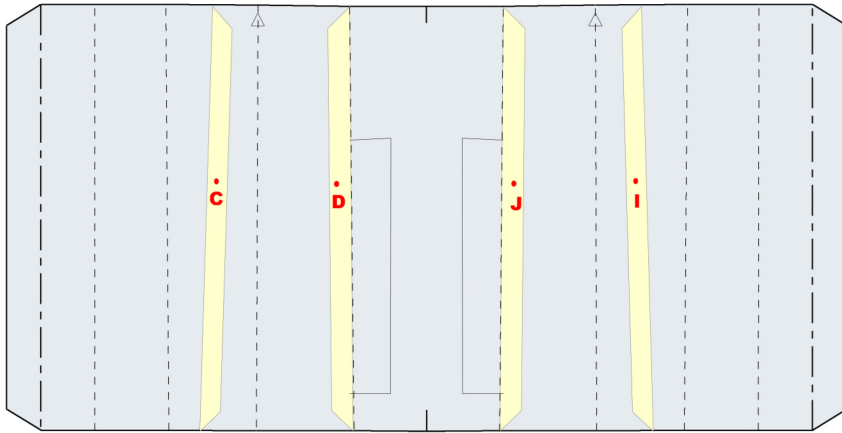
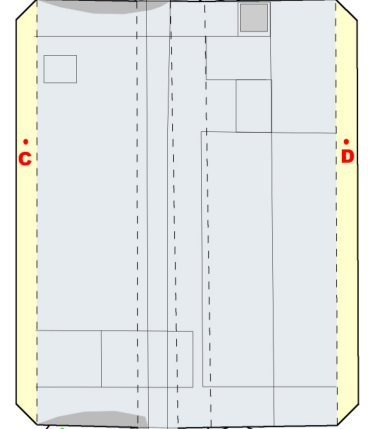
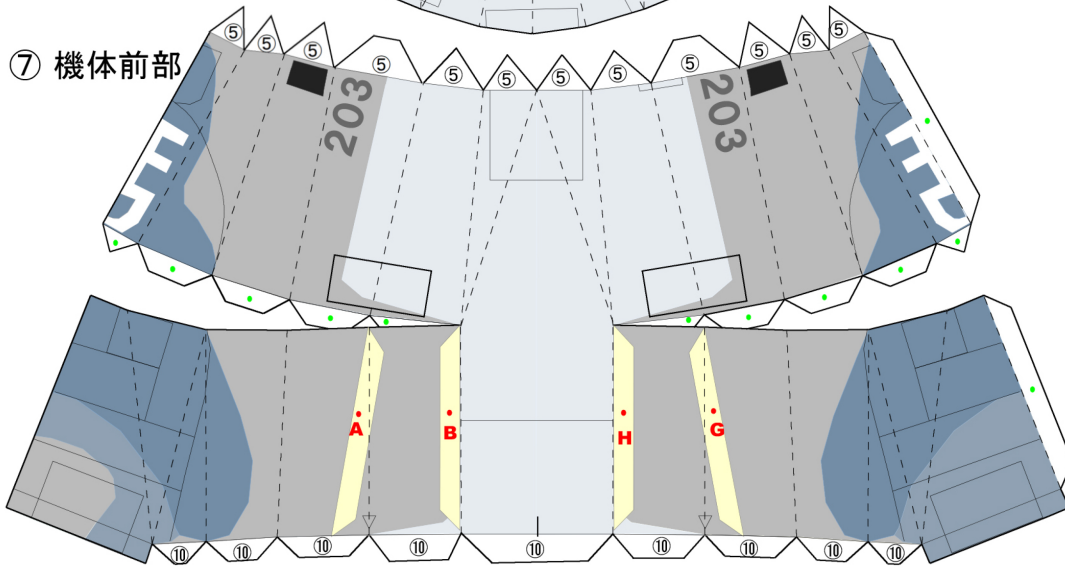

⑩ 機体中央1

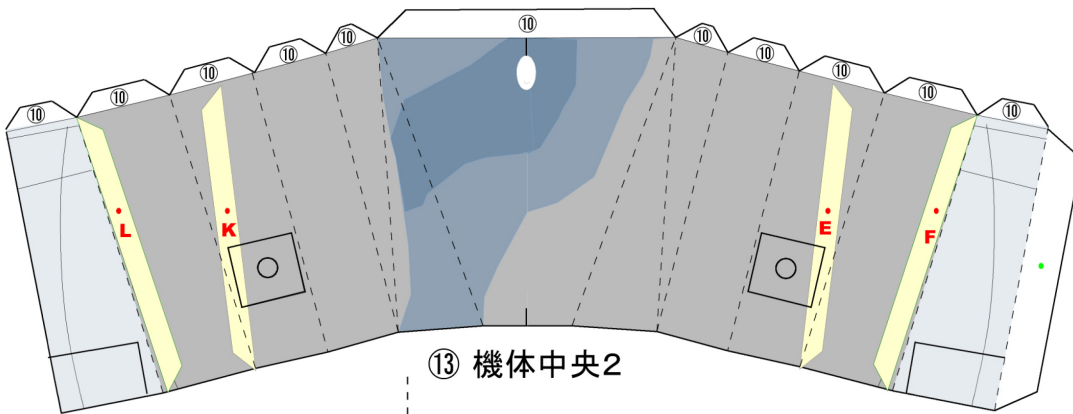
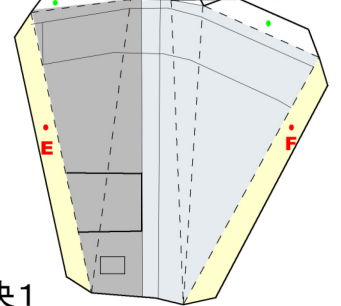



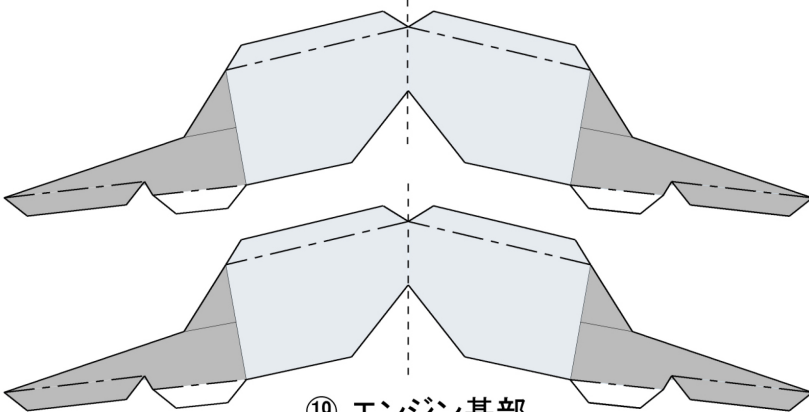
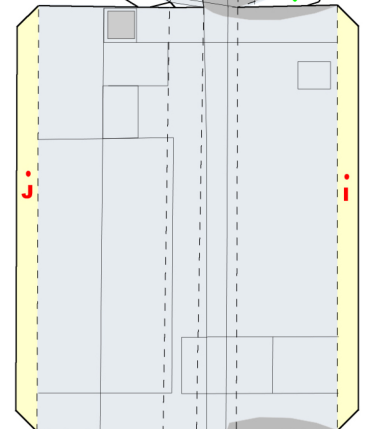
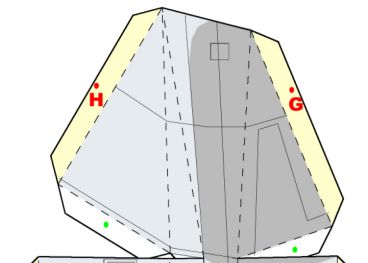

⑬ 機体中央2

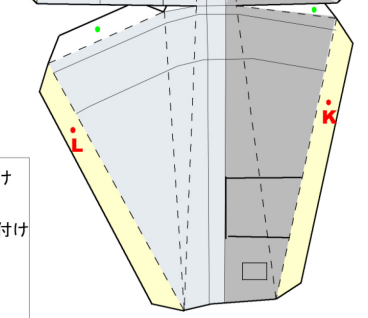

⑲ エンジン基部

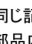

⑮ 車輪ハウス左

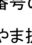
-  同じ記号どうしを糊付け
-  部品内で糊付け
-  番号の部品の裏に糊付け
-  やま折り
-  たに折り
-  切り線

22 エンジン前部2

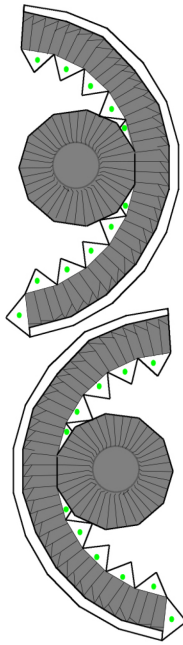

12 機体後部1

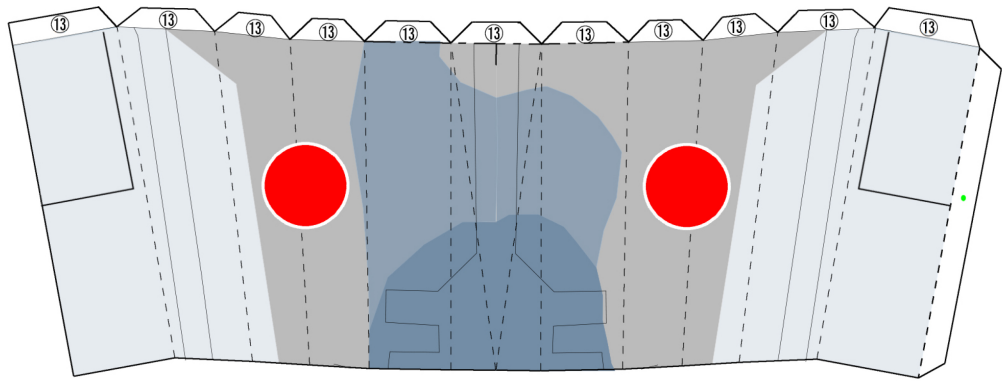

3 主翼補強左

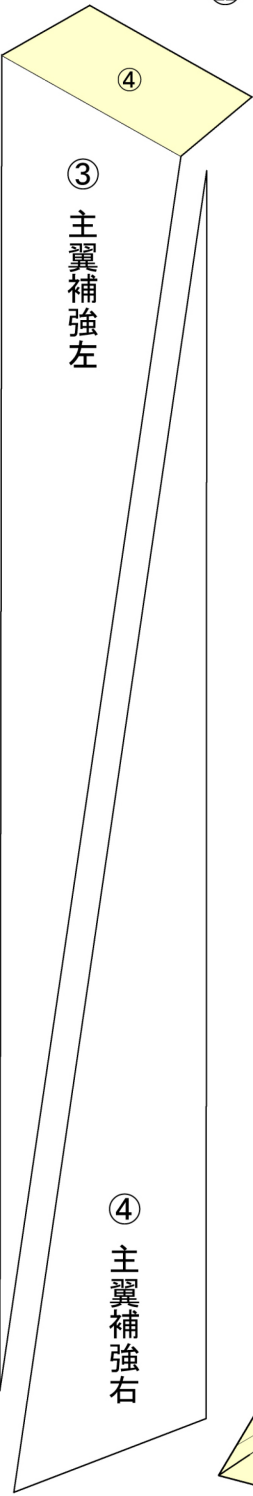

4 主翼補強右

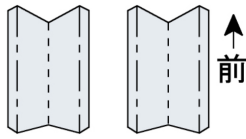

24 フィン

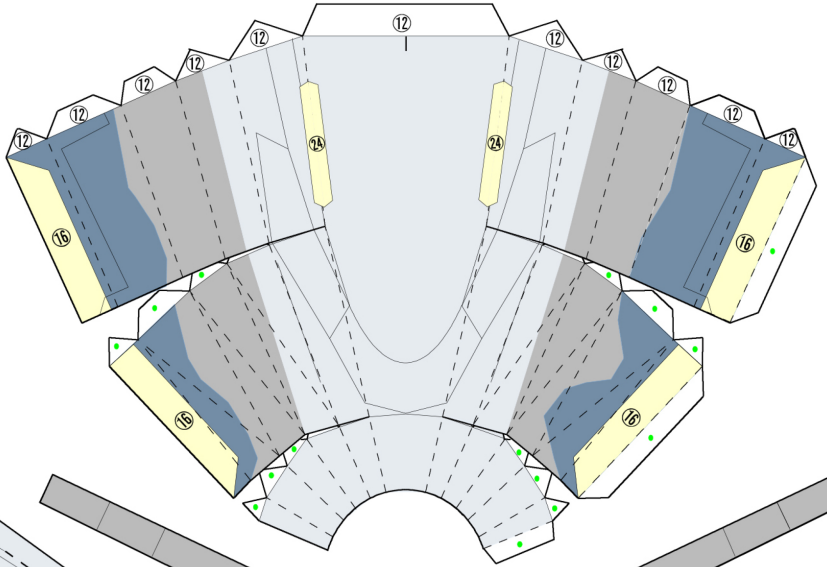

11 機体後部2

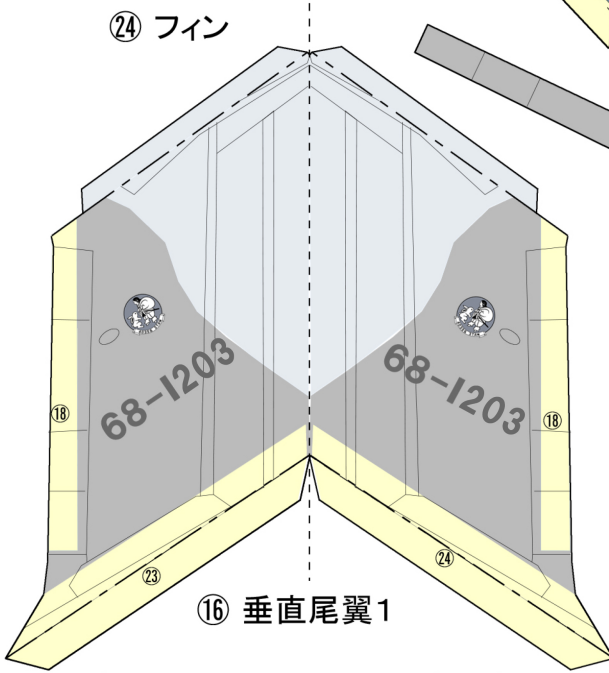

16 垂直尾翼1

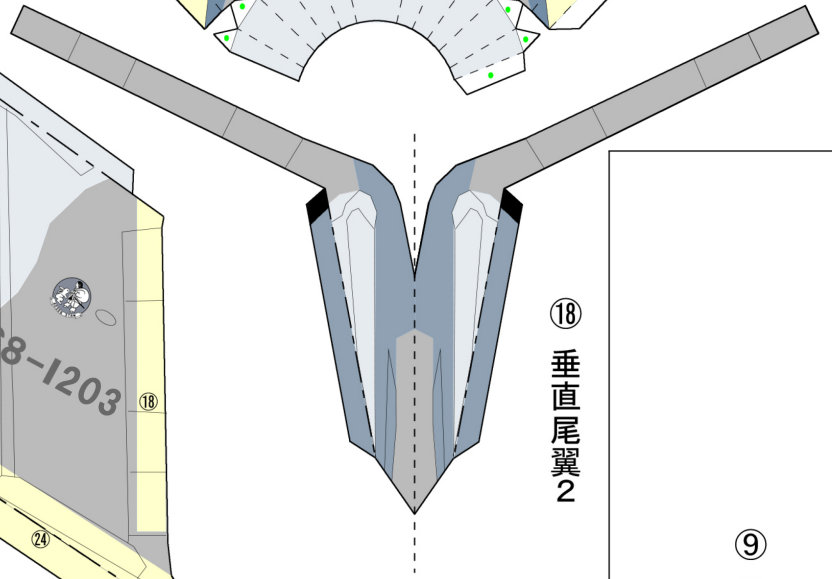

18 垂直尾翼2

9 機首おもり2

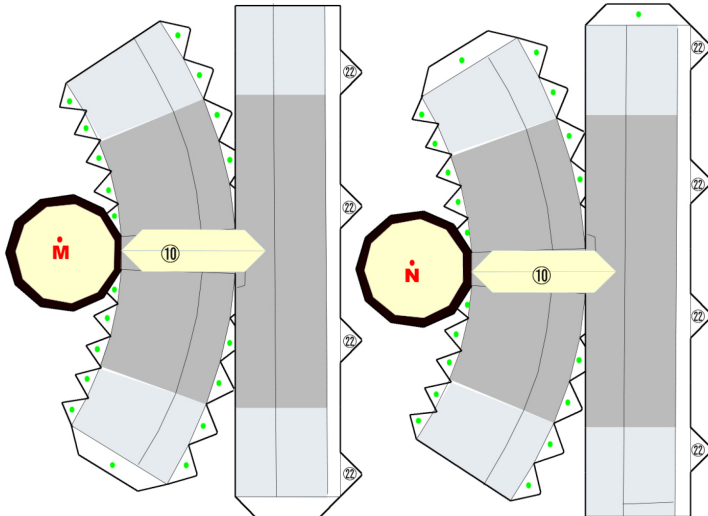
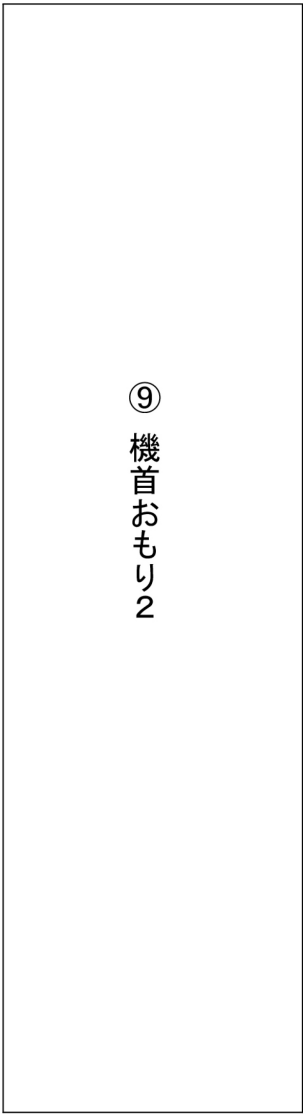

20 エンジン前部1

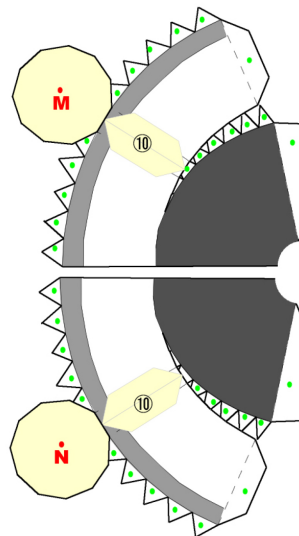

21 エンジン後部